

VIEW J-J

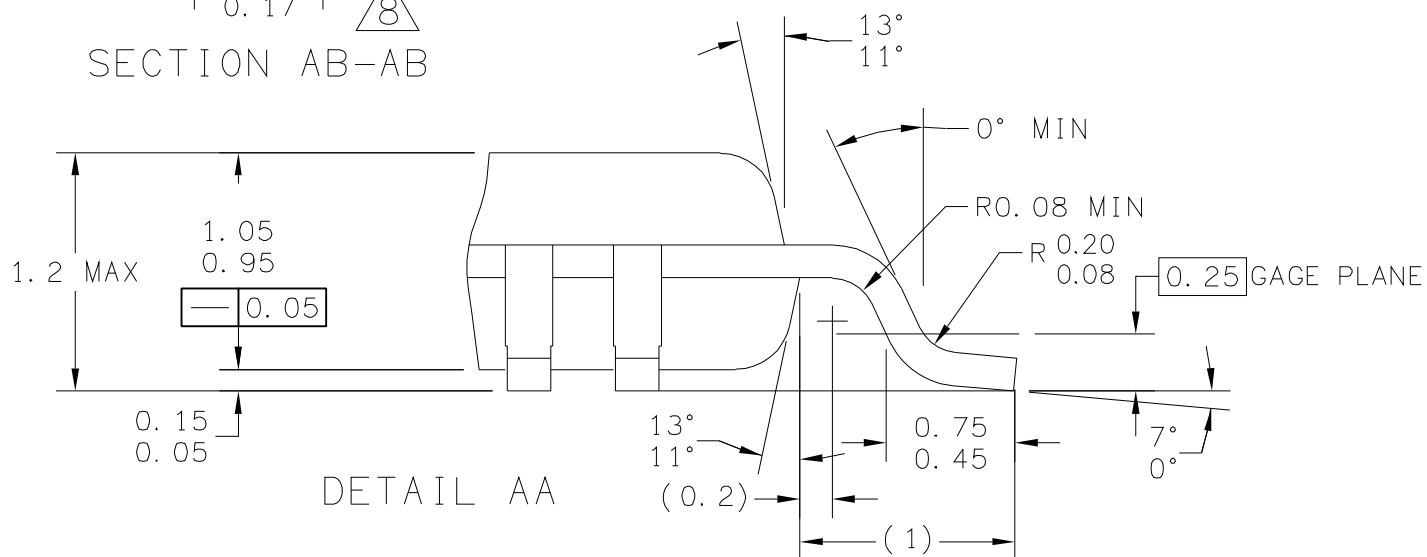
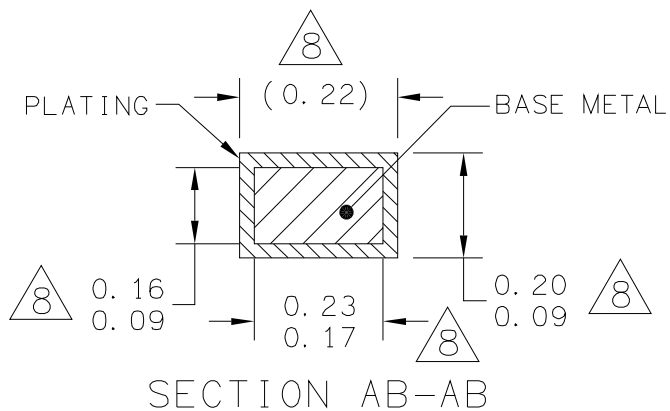

© FREESCALE SEMICONDUCTOR, INC.  
ALL RIGHTS RESERVED.

# MECHANICAL OUTLINE

PRINT VERSION NOT TO SCALE

TITLE:  
TQFP, 48LD LEAD, 7X7X1 PKG,  
0.5 PITCH, EXPOSED PAD

DOCUMENT NO: 98ASA10827D

REV: 0

CASE NUMBER: 2018-01

02 APR 2008

STANDARD: JEDEC-MS-026 ABC



NOTES:

- 1. DIMENSIONS ARE IN MILLIMETERS.
- 2. INTERPRET DIMENSIONS AND TOLERANCES PER ASME Y14.5M-1994.
- 3. DATUMS A, B, AND D TO BE DETERMINED AT DATUM PLANE H.
- 4. DIMENSIONS TO BE DETERMINED AT SEATING PLANE C.
- 5. DIMENSION DOES NOT INCLUDE DAMBAR PROTRUSION. ALLOWABLE DAMBAR PROTRUSION SHALL NOT CAUSE THE LEAD WIDTH TO EXCEED THE MAXIMUM DIMENSION BY MORE THAN 0.08-MM. DAMBAR CANNOT BE LOCATED ON THE LOWER RADIUS OR THE FOOT. MINIMUM SPACE BETWEEN PROTRUSION AND ADJACENT LEAD OR PROTRUSION: 0.07-MM.
- 6. DIMENSIONS DO NOT INCLUDE MOLD PROTRUSION. ALLOWABLE PROTRUSION IS 0.25-MM PER SIDE. DIMENSIONS ARE MAXIMUM PLASTIC BODY SIZE DIMENSIONS INCLUDING MOLD MISMATCH.
- 7. EXACT SHAPE OF EACH CORNER IS OPTIONAL.
- 8. THESE DIMENSIONS APPLY TO THE FLAT SECTION OF THE LEAD BETWEEN 0.1-MM AND 0.25-MM FROM THE LEAD TIP.

© FREESCALE SEMICONDUCTOR, INC. ALL RIGHTS RESERVED.	MECHANICAL OUTLINE	PRINT VERSION NOT TO SCALE	
TITLE: TQFP, 48LD LEAD, 7X7X1 PKG, 0.5 PITCH, EXPOSED PAD	DOCUMENT NO: 98ASA10827D		REV: 0
	CASE NUMBER: 2018-01		02 APR 2008
	STANDARD: JEDEC-MS-026 ABC		